

## CCS ASSEMBLY INSTRUCTIONS

BY SIMPLY FOLLOWING THESE STEP-BY-STEP INSTRUCTIONS,  
YOU WILL SOON BE ENJOYING YOUR NEW DRAPERY HARDWARE.

### CCS ASSEMBLY

#### Materials Needed:

CCS Track 511\*\*-25

Cord 009004-25

CCS End Pulley 052801-25

CCS End Pulley (Short)\* 052802-25

CCS Cord Connector 052510-25

CCS Overlap Master 052508-25

CCS Underlap Master 052509-25

Klick Carrier 052008-25

- \* For use with one-way draw systems
  - \*\* Components (except cord and connectors) also available in brown (color code 65 instead of 25)
  - Determining track cut length: For center draw, subtract 3.25" from total length of track. For one-way draw systems using white track, subtract 2.25". For one-way draw systems using brown track, subtract 2.625". (This allows for the length of the pulleys)
  - Determining amount of cord needed: The total length of the track plus the length of the cord drop, then multiplied by two. Add eight inches for adjustability and cord shrinkage. Cut the nylon cord by heating with a lighter to prevent fraying.
1. Push both ends of the cord through the outside end of the first end pulley and slide both cords through the track. Fix first pulley onto the track. This will be the "drop side" of the track. On the other end of the track; pull excess cord until about six inches hangs out of each channel.
  2. When looking at the end of the track, you will see two cords coming out of the channel; we will refer to these as the right and left side.
  3. Attach cord connector #1 to the very end of the cord hanging out of the right channel and remove these screws. Note: Use a #1 Phillips screwdriver or drill bit in good condition to avoid marring the head of the screw. Pull the cord through about 4 inches toward you.
  4. Pull the cord hanging out of the left channel through the inside left of the 2nd end pulley and loop the cord back through the right side. This makes a continuous loop with the cord.
  5. Attach cord connector #2 to this end of the cord. Slide the connector about 4 inches away from this end of the cord to allow for adjustability. Remove these screws.
  6. Fix the cord connector #3 to the left side of the cord between the hanging end pulley and the track. Do not tighten or remove these screws yet.

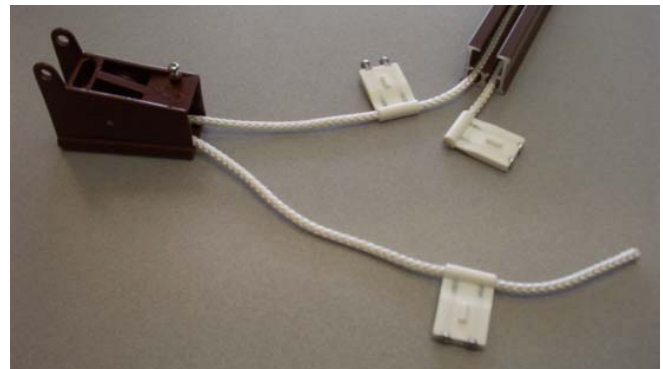

**Cord Connector placement (ignore the tightened screws)**

7. The order in which you add the master carriers to the track will determine which side your cord hangs from. For a cord drop on the right side of the track, slide the overlap master carrier on first with cord connectors #1 and #2 sliding into the cord channels. Push the 4 inch cord ends up through the hole in the center of the master so that they extend above the track. Tie them together using a basic square knot. Then slide the underlap master onto the track with connector #3 sliding into the channel. For a cord drop on the left, slide the underlap master on first and then the overlap.
8. Attach the last end pulley onto the track.
9. On this end pulley, ensure the cord loop is not wrapped around the metal pin inside the end pulley.
10. Pull the cord on the drop side so that the master carriers are in the open position against each end pulley. You may need to push one in place with your hand. With both masters in this position, tighten the screws on cord connector # 3. Now the master carriers are centered.
11. By pulling the cord through the big gap of the end pulley on the drop side, it will hang straight behind the curtain and is ready to operate.
12. At this point, carriers may be "klicked" into the track.

#### One-Way Draw Systems

1. Follow steps 1-3.
2. Follow steps 4 and 5 using a short end pulley.
3. Slide an underlap master carrier onto the track with both cord connectors sliding into the channel. The arm should point back towards the short end pulley. For a one-way right, reverse the arm. For both one way right and left, shift the master arm down one position so that the arm will completely overlap the short end pulley.
4. Attach the short end pulley onto the track. Tighten the screw.
5. Follow step 9.
6. Follow steps 11 and 12.

Watch the CCS Assembly Video.



# CCS INSTALL INSTRUCTIONS

BY SIMPLY FOLLOWING THESE STEP-BY-STEP INSTRUCTIONS, YOU WILL SOON BE ENJOYING YOUR NEW DRAPERY HARDWARE.

## Getting Started:

Please read through all instructions carefully before you begin.

Unpack all materials making sure all components are included:

- Track(s)
- Master carrier(s) & carriers (pre-installed within track)
- Mounting brackets
- Splice, if requested

## Tools You Will Need:

- Drill with a 1/8" bit and a Phillips bit
- Phillips screwdriver
- Metal tape measure
- Hack saw (optional)

## Wall Mount Instructions:

### Installing Your Drapery Track:

#### 1. Measure

Determine the height of the top of track and mark bracket height on the wall for all the brackets and adjust (as necessary) to make sure they are all leveled.

#### 2. Mark

Measure the width of the track and mark the two end brackets approximately 3" - 4" in from the ends of the track. Evenly space the remaining brackets and place corresponding marks.

#### 3. Mount

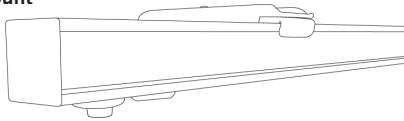

To attach the bracket to the wall; first pre-drill holes for screw diameter when mounting into wood frame of window or wall stud. Otherwise, pre-drill and install anchors first before fastening with screws.

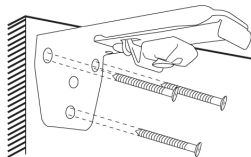

#### 4. Attach Bracket

Place the track into the bracket as shown in the drawing; applying pressure until track "clicks" into bracket. Make sure track set screw is loose enough to allow the track retainer to flex. Repeat this step for the remaining brackets.

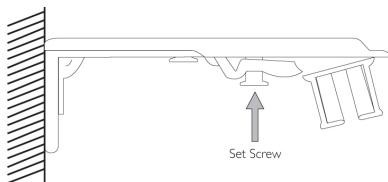

#### 5. Tighten

Tighten track set screws on all the brackets to secure track to brackets.

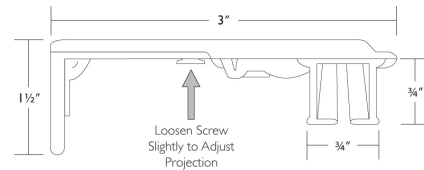

#### 6. Adjust Projection

Adjust track to the desired projection. Projection is adjustable from 3" - 4 1/2". Repeat this step for the remaining brackets.

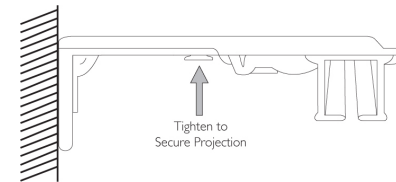

Once desired projection is set for all the brackets, lock the bracket into position by tightening the track depth adjustment set screw (see drawing below).

## Installing Splice, if requested:

For wide areas, tracks will be shipped in multiple pieces and will require a splice.

- Slide the track of the connecting ends on each track into the channel of the splice and butt ends together.
- Tighten locking screw with hex key for a secure fit.

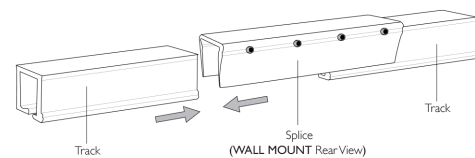

## CCS INSTALL INSTRUCTIONS (CONTINUED)

BY SIMPLY FOLLOWING THESE STEP-BY-STEP INSTRUCTIONS, YOU WILL SOON BE ENJOYING YOUR NEW DRAPERY HARDWARE.

### Ceiling Mount Instructions:

#### Installing Your Drapery Track:

**1. Measure**

Measure the width of the track and mark the two end brackets approximately 3" - 4" in from the ends of the track. Evenly space the remaining brackets and place corresponding marks.

**2. Mount**

To attach the bracket to the ceiling; first pre-drill holes for screw diameter when mounting into wood frame of window or wall stud. Otherwise, pre-drill and install anchors first before fastening with screws.

**3. Attach Bracket**

Place the track into the bracket as shown in the drawing; applying pressure until track "clicks" into bracket. Make sure track set screw is loose enough to allow the track retainer to flex. Repeat this step for the remaining brackets.

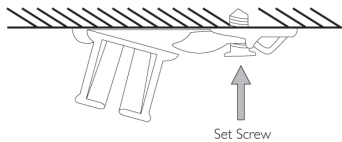

**4. Tighten**

Tighten track set screws on all the brackets to secure track to brackets.

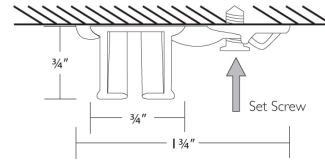

#### Installing Splice, if requested:

For wide areas, tracks will be shipped in multiple pieces and will require a splice.

- Slide the track of the connecting ends on each track into the channel of the splice and butt ends together.
- The tracks will snap together. Press together and confirm a tight fit.
- Secure with additional screw.

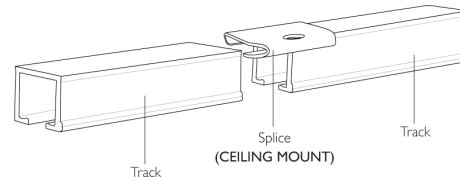

# 49502-00 TENSION DEVICE FOR CHILD SAFETY

## ASSEMBLY & INSTALLATION INSTRUCTIONS

BY SIMPLY FOLLOWING THESE STEP-BY-STEP INSTRUCTIONS, YOU WILL SOON BE ENJOYING YOUR NEW WINDOW TREATMENT.

### Getting Started:

Please read through all instructions carefully before you begin.

Unpack all materials making sure all components are included:



### Tools You Will Need:

- Phillips screwdriver or drill with Phillips bit
- Optional anchors if needed

### Assembling the 49502-00 Tension Device:

1. Place bead chain/cord on the bottom groove of the base.
2. Snap cover onto the base.
3. Pull the chain/cord out of the groove.

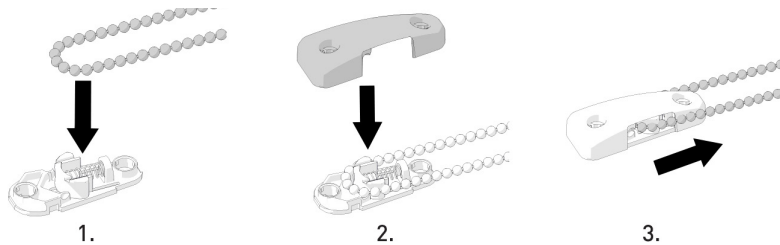

### Installing the 49502-00 Tension Device:

1. Pull the Chainhold down until the chain/cord is fully tensioned (plunger will be fully raised).
2. Mark screw hole locations.
3. Screw device into wall.

#### Direct Mount

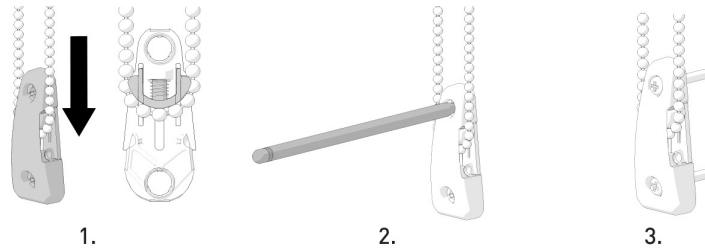

#### Outside Mount

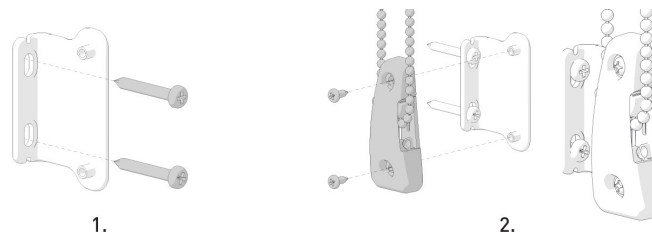

#### Side Mount



## CCS CHANGING THE CORD DROP SIDE / ADJUSTING CORD LENGTH

BY SIMPLY FOLLOWING THESE STEP-BY-STEP INSTRUCTIONS, YOU WILL SOON BE ENJOYING YOUR NEW DRAPERY HARDWARE.

### CCS CORDED TRACK - CHANGING THE CORD DROP SIDE

1. Loosen the screw of the cord connector that is with the master on the opposite side of the cord drop. This should be the only cord connector with that master.
2. Pull the cord drop until both masters are pressed together closest to the pulley on the opposite side of the cord drop.
3. Loosen the screw on the end pulley on the opposite side of the cord drop. Keeping the cord in the pulley, remove the pulley from the track. The carriers in the track on this side will fall out and should be set aside until the end.
4. Both masters should be easily removed from the track. The second master will be tied into place, but can easily be untied. Switch the masters around and place them back into the track. Two cord connectors go in the master on the side of the cord drop. One cord connector goes into the other master.
5. Make sure the arms are facing each other. Click any carriers back into the track that came out during the switch. The curve of the carriers should be facing the same way as the master arms.
6. With all the carriers in the track, pull the cord until the masters are spread as far apart as possible.
7. Tighten the screws of the cord connector on the opposite side of the cord drop. This is the final step.



Watch the Video.

### CCS CORDED TRACK - ADJUSTING CORD LENGTH

#### For Center Draw Systems:

- There will be three (3) cord connectors on a track system that are center-draw. The placement of these connectors is dependent on which side of the track the cord hangs.
  - There will always be two connectors inside of the master carrier closest to the cord. (For example: when the drop is on the right side, the two (2) connectors will be inside the right overlap master carrier. When the drop is on the left side, the two (2) connectors will be on the left underlap master.)
  - The third cord connector will always be on the other master carrier.
  - The two (2) screws in each cord connector are extremely small and require a #1 phillips screwdriver or drill bit in good condition. Otherwise, you will mar the head of the screw, making it more difficult to work with. The two screws should be loosened at least 1/4" or more. There is no danger in loosening them too much; this won't cause your track to fall apart.
1. Loosen the solitary cord connector on one of the master carriers.
  2. Of the two (2) cord connectors inside the master carrier closest to the cord drop side, loosen only the one connector farthest away from the hanging cord side. **DO NOT LOOSEN THE SCREWS ON THE CONNECTOR CLOSEST TO THE CORD DROP.** This will cause the whole system to come apart when you begin pulling the cord to shorten it.
  3. There is a short piece of cord hanging out of one of the master carriers that is there specifically for the purpose of shortening the cord drop length. Pull on this cord until desired cord length is reached. If the cord will not pull, loosen the screws more on the two connectors.
  4. Once desired length is reached, singe the cord with a lighter to cut the excess and wrap the rest around the notch in the master carrier.
  5. Leaving the solitary connector alone for the moment, tighten the screws again on the other loose cord connector. **DO NOT OVER-TIGHTEN THE CORD CONNECTORS. THE TOP OF THE SCREW HEAD SHOULD BE FLUSH WITH THE TOP OF THE CONNECTOR.**
  6. The master carriers will no longer be centered at this point. To re-align the master carriers, pull the cord so both masters are as far as they can travel in the open direction. If one will not move, you may need to move the master by hand.
  7. Tighten the final solitary connector. The track should now be aligned to the center.



Watch the Video.