

BENDS & CURVES

Forest can bend and curve many of our tracks and decorative rods, including motorized rods.

*FOREST BENDING & CURVING SERVICE
FOREST BENDING & CURVING EQUIPMENT*

THE WORLD
BEHIND
YOUR
DRAPERIES



CUSTOM BEND & CURVE TRACKS AND H-RAIL

- Forest will custom bend and curve hardware to your exact specifications. Or, bend and curve at your workroom with our equipment.
- All bend and curve orders require a template at actual size. Mail your template to Forest Drapery Hardware, 2500 Donn Drive, Cartersville GA 30120, Attn: Inside Sales.
- Please note bent and curved rods hold 20% less weight than straight rods.

NEED HELP
MAKING A TEMPLATE?
CLICK OR SCAN!



CS Track



CCS Track



KS Track



CS Recess



DS Track



FMS Track



Dresden Traverse

*Polished chrome and wood foil
finishes cannot be bent or curved*



Deventer CRS
Deventer MRS

KS/DS BENDER



Scan for a video showing how to set up
the KS/DS Bender

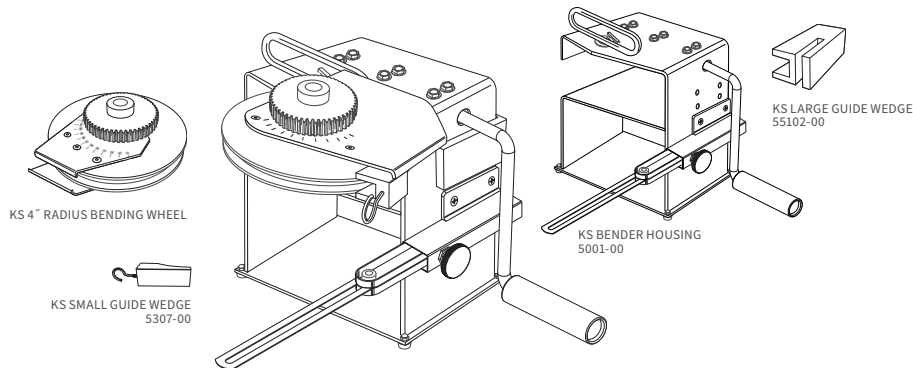

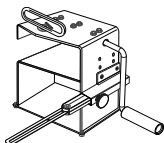
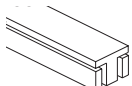
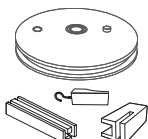
KS & DS	COMPONENT	
•		KS/DS Housing Unit 5001-00
•		Bending Strips with 2 filler strips 5302-00 KS 5312-00 DS
•		Bending Wheel Sets Includes wheel, wedges, and bending strips. 55401-00 KS, 4" radius 55402-00 DS, 4" radius

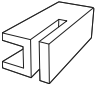
KS & DS	COMPONENT	
•		Small Guide Wedge 5307-00 KS (pictured) 5308-00 DS white 5309-00 DS grey Both DS wedges are required.
•		Large Guide Wedge 55102-00 KS (pictured) 55103-00 DS white 55104-00 DS grey Both DS wedges are required.

CS/CCS/FMS/H-RAIL BENDER



Scan for a video showing how to set up
the CS/CCS/RTS/FMS/H-RAIL Bender

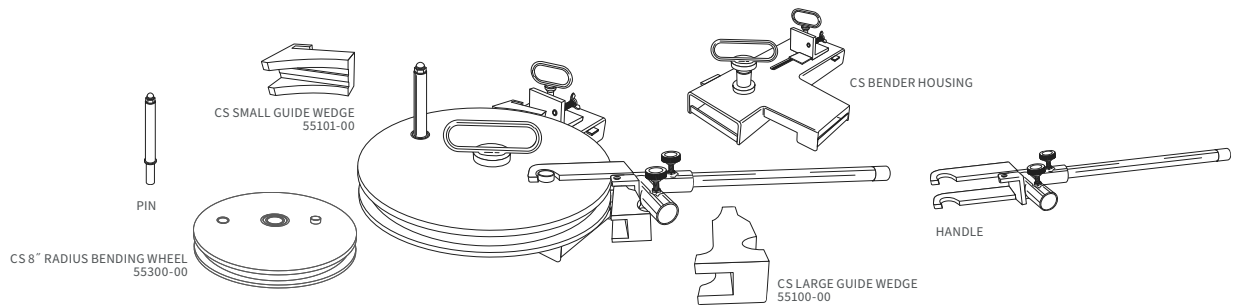

CS, CCS, FMS, H-RAIL	COMPONENT	
•	CS/CCS/FMS/H-RAIL Housing Unit with handle & pin 55002-00	
•	CS Bending Strip includes two filler strips 55302-00	
•	CS Recess Bending Strip four piece set 55321-00	
•	CCS Bending Strip includes two filler strips 55303-00	
•	FMS Bending Strip includes two filler strips 55306-00	
•	H-Rail Bending Strip 55314-00	

CS, CCS, FMS, H-RAIL	COMPONENT	
•	Bending Wheels & wedges 55300-00 CS/CCS/FMS, 8" radius 55310-00 H-Rail, 8" radius 55320-00 CS Recess, 8" radius	
•	Small Guide Wedge 55101-00 CS/CCS/FMS 55315-00 H-Rail	
•	Large Guide Wedge 55100-00 CS/CCS/FMS 55316-00 H-Rail	
•	Extension Arm for handle 55317-00	
•	Stand for CS Bender 55318-00	

KS/DS/CS/CCS/FMS/H-RAIL CURVING

CURVING	COMPONENT	
•	Electronic Continuous Curver 110 Volt curver for accurate and high output curving. Wheels not included. 5004-00	
•	Curving Wheels, set of 3 5304-00 KS 5306-00 DS 5305-00 CS/CCS/FMS 55311-00 H-Rail	

CURVING	COMPONENT	
•	KS Curving Strip, 23' 55308-00	
•	DS/CCS Curving Strip, 23' 55304-00	
•	CS/FMS Curving Strip, 23' 55307-00	
•	H-Rail Curving Strip, 23' 55313-00	

Forest specializes in the development, production and supply of highly innovative drapery tracks and window coverings. We offer track solutions catering to the hospitality industry. Whether you choose our motorized tracks or rods, shades or hand drawn rods your client will experience comfortable luxury and optimal ease of use.

THE WORLD BEHIND YOUR DRAPERIES

More than thirty years ago it started with a flexible aluminum system, known as the Forest KS® system. The product line was expanded at a rapid pace, always focusing on functionality and quality. The technologies conquered the world. Hotels across the globe are satisfied users of Forest systems including iconic hotels like the Venetian, Hardrock and the mega hotels in Dubai.

Forest Group B.V. sells its products in more than 100 countries worldwide and has sales offices in The Netherlands, the United States, China, United Arab Emirates, United Kingdom and Poland, ensuring global availability.

Some well-known and recognized features of the Forest track systems are:

- **High-quality standards:** We guarantee a long lifespan.
- **Comfort and quiet:** Drapes open and close silently, creating a serene and comfortable environment.
- **Adds style to windows:** Always perfectly hanging drapery thanks to our systems, including motorized solutions.
- **Smart integration:** Controllable via app, voice, and home automation systems for ultimate convenience.
- **Sustainability:** We use a minimum of 75% recycled aluminum in our tracks.
- **Unique warranty:** 10-year warranty.



Drapery engineering by Forest