

CORDOBA MOTORIZED INSTALLATION INSTRUCTIONS

BY SIMPLY FOLLOWING THESE STEP-BY-STEP INSTRUCTIONS, YOU WILL SOON BE ENJOYING YOUR NEW DRAPERY HARDWARE.

Getting Started:

Please read through all instructions carefully before you begin.

Unpack all materials making sure all components are included:

- Routed wood pole
- Aluminum traversing track (assembled with carriers)
- Wall mount brackets
- Decorative finials (if ordered)
- C-Ring and hardware (optional)

Tools You Will Need:

- Drill with a 1/8" bit and a Phillips bit
- Phillips screwdriver
- Metal tape measure
- #6 x 3/4" wood screws for mounting wood pole to bracket



Scan or click this QR code to go directly to the installation video on our YouTube channel.

Installing Your Cordoba Motorized Hardware:

Your routed wood drapery pole has been sent partially assembled. You will need to install the brackets, secure the pole to the brackets, add the track, and then hang your drapes.

This guide will assist you in installing your brackets into the wall, mounting the wood pole to the bracket, and inserting the track into the wood pole assembly.

1. Install bracket to the wall using standard installation methods. Mounting screws not included, different anchors or screws are needed depending on mounting surface.

Note: If installing C-Ring carriers, see C-Ring Assembly first.

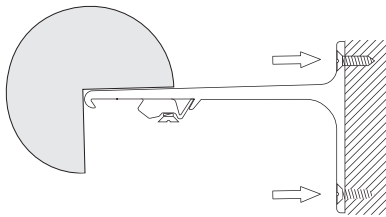

2. Attach wood pole to brackets. We recommend using #6 3/4" screws. Start 4" from each side for right and left brackets, then install center support(s).

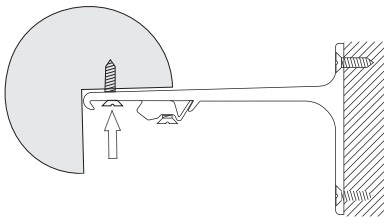

3. Loosen Smart-Klick fastener screw. Place track into bracket, applying pressure until the track clicks into place.

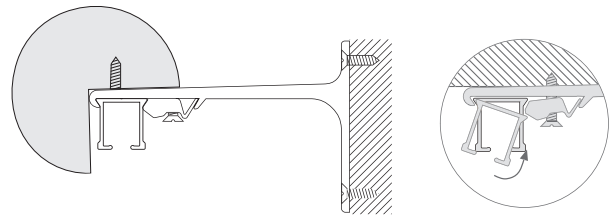

4. Tighten screw (careful not to over-tighten) to lock the track into place.

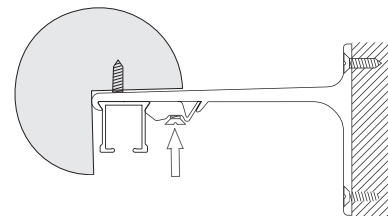

Optional C-Ring Assembly:

If you are enhancing the decorative appeal of your wood pole with C-Rings, see the diagram below for instructions on attaching wood rings. The carriers for your C-Rings are already installed on the track. Screw your C-Ring into the top hole of the carriers, as shown below. **IMPORTANT:** If using C-Rings, attach them to the carriers prior to attaching your track to the brackets.

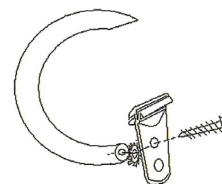

FOREST SHUTTLE MOTORS QUICK START GUIDE

BY SIMPLY FOLLOWING THESE STEP-BY-STEP INSTRUCTIONS,
YOU WILL SOON BE ENJOYING YOUR NEW MOTORIZED DRAPERY HARDWARE.

Getting Started:

Please read through all instructions carefully before you begin.

Make sure to check these items before programming:

- Motor is plugged in
- Batteries are in the remote or wall switch
- Drapes are in the open position

Technical Specifications:

- Voltage: 24Vdc
- Max. power: 65W
- Torque: 1.5Nm
- Speed: 15cm/sec

Programming Instructions:

- Before running the motor, make sure drapes are in the open position.
- Turn motor into motor pulley and lock in place.
- Plug motor into outlet.
- Tug master carriers toward the closed position (drapes covering window) – they will move automatically.
- After fully closed, tug masters back to the open position – they will move automatically.
- Once fully opened, a yellow LED light will be lit on the bottom of the motor. While lit, you have 10 seconds to move the master carriers to whatever stacking position you desire.
- Make sure battery is in remote or wall switch.
- Go to the channel you want to program drapery motor to be on when using the remote or wall switch.
- Press the programming button on the bottom of the motor three times. You will see it switch from a green to yellow and back to green LED. After third press (ending up on green LED), let go and quickly press and hold, green LED will start flashing.
- While the LED is flashing green, press open on the remote or wall switch. Green LED will stop flashing.
- Press close to see if draperies start moving. If they do, you are finished. If not, go back to the beginning and start over.

Resetting Motor to Factory Default

- Resetting the motor to factory default settings will erase any limits and or program setting made prior.
- Press the programming button on the bottom of the motor 16 times. The LED's will correspond switching from green to yellow and so on.
- You will end up on a yellow LED after pressing 16 times. Quickly let go, then press and hold – yellow LED will start flashing.
- Let flashing yellow LED time out.

Resetting Limits

- Start with drapes in the open position.
- Press programming button 4 times, it will correspond with blink-ing LED's green, yellow, green, yellow.
- End up on yellow LED and quickly let go and yellow LED will start flashing.
- Let flashing yellow LED time out.
- Tug drapes toward close position and let them close all the way.
- Tug drapes toward open position and let them open all the way.
- Yellow LED will be lit, you have 10 seconds to move drapes to proper stacking position.

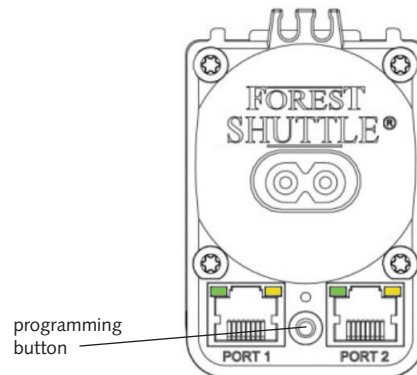

Warranty Disclaimer

The Forest Shuttle is not suitable for humid spaces, like bathrooms or outside. Forest does not assume liability for resulting damages to property or personal injury if the product has been abused in any way or damaged by improper use or failure to observe these operating instructions.



Scan or click this QR Code to go directly to the Shuttle programming video on the Forest YouTube channel.