

CORDOBA TRAVERSING INSTALLATION INSTRUCTIONS

BY SIMPLY FOLLOWING THESE STEP-BY-STEP INSTRUCTIONS, YOU WILL SOON BE ENJOYING YOUR NEW DRAPERY HARDWARE.

Getting Started:

Please read through all instructions carefully before you begin.

Unpack all materials making sure all components are included:

- Routed wood pole
- Aluminum traversing track (assembled with carriers)
- Wall mount brackets
- Decorative finials (if ordered)
- C-Ring and hardware (optional)

Tools You Will Need:

- Drill with a 1/8" bit and a Phillips bit
- Phillips screwdriver
- Metal tape measure
- #6 x 3/4" wood screws for mounting wood pole to bracket



Scan or click this QR code to go directly to the installation video on our YouTube channel.

Installing Your Cordoba Traversing Hardware:

Your routed wood drapery pole has been sent partially assembled. You will need to install the brackets, secure the pole to the brackets, add the track, and then hang your drapes.

This guide will assist you in installing your brackets into the wall, mounting the wood pole to the bracket, and inserting the track into the wood pole assembly.

1. Install bracket to the wall using standard installation methods. Mounting screws not included, different anchors or screws are needed depending on mounting surface.

Note: If installing C-Ring carriers, see C-Ring Assembly first.

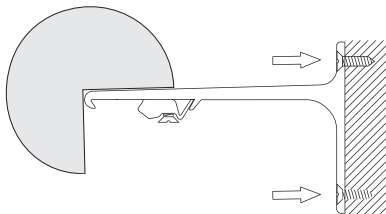

2. Attach wood pole to brackets. We recommend using #6 3/4" screws. Start 4" from each side for right and left brackets, then install center support(s).

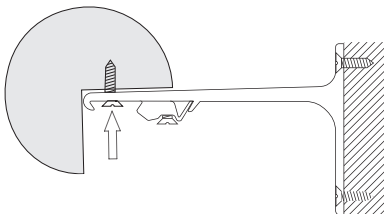

3. Loosen Smart-Klick fastener screw. Place track into bracket, applying pressure until the track clicks into place.

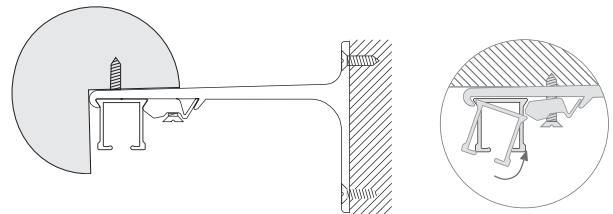

4. Tighten screw (careful not to over-tighten) to lock the track into place.

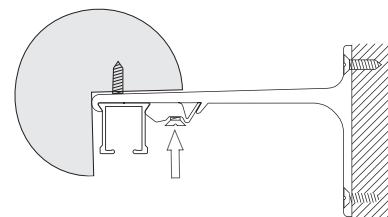

Optional C-Ring Assembly:

If you are enhancing the decorative appeal of your wood pole with C-Rings, see the diagram below for instructions on attaching wood rings. The carriers for your C-Rings are already installed on the track. Screw your C-Ring into the top hole of the carriers, as shown below. IMPORTANT: If using C-Rings, attach them to the carriers prior to attaching your track to the brackets.

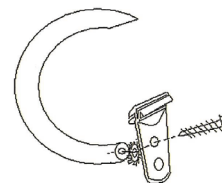

49502-00 TENSION DEVICE FOR CHILD SAFETY

ASSEMBLY & INSTALLATION INSTRUCTIONS

BY SIMPLY FOLLOWING THESE STEP-BY-STEP INSTRUCTIONS, YOU WILL SOON BE ENJOYING YOUR NEW WINDOW TREATMENT.

Getting Started:

Please read through all instructions carefully before you begin.

Unpack all materials making sure all components are included:



Tools You Will Need:

- Phillips screwdriver or drill with Phillips bit
- Optional anchors if needed

Assembling the 49502-00 Tension Device:

1. Place bead chain/cord on the bottom groove of the base.
2. Snap cover onto the base.
3. Pull the chain/cord out of the groove.

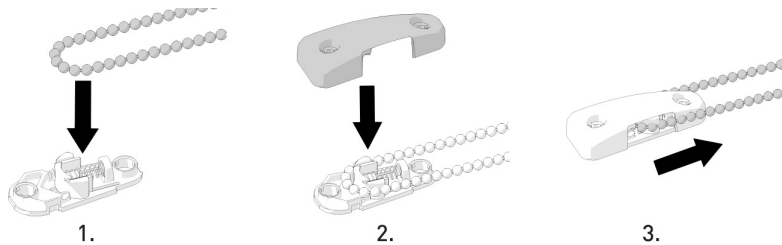

Installing the 49502-00 Tension Device:

1. Pull the Chainhold down until the chain/cord is fully tensioned (plunger will be fully raised).
2. Mark screw hole locations.
3. Screw device into wall.

Direct Mount

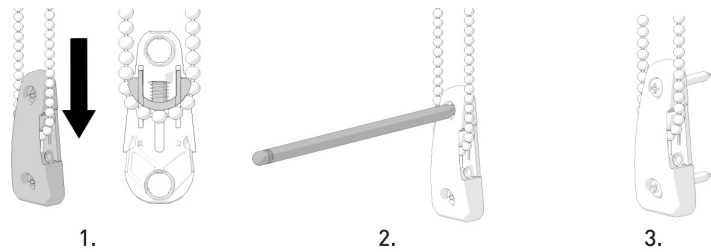

Outside Mount

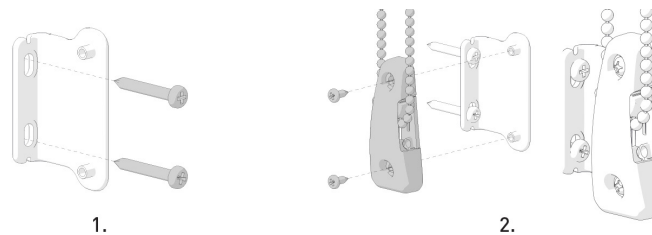

Side Mount

